

1080P HDMI™ Extender with KVM over CAT6/6a Cable (100m)



User Manual

VER 1.1

Thank you for purchasing this product

For optimum performance and safety, please read these instructions carefully before connecting, operating or adjusting this product. Please keep this manual for future reference.

Surge protection device recommended

This product contains sensitive electrical components that may be damaged by electrical spikes, surges, electric shock, lightning strikes, etc. Use of surge protection systems is highly recommended in order to protect and extend the life of your equipment.

Caution

The product requires the use of UTP connectors. Please connect in direct interconnection method and do not cross connect.

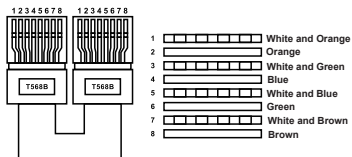

Direct Interconnection Method

Table of Contents

1. Introduction.....	1
2. Features.....	1
3. Package Contents.....	1
4. Specifications.....	2
5. Operation Controls and Functions.....	3
5.1 Transmitter Panel.....	3
5.2 Receiver Panel.....	4
6. Application Example.....	5

1. Introduction

This 1080P HDMI Extender can extend HDMI video/audio signal up to 100m/328ft over CAT6/6a cable, achieving zero-delay and uncompressed long-distance transmission between the signal source and display device. Video resolution is up to 1080P@60Hz. It supports EDID copy pass-through on source and sink end, along with PoC and KVM extending synchronously.

This multi-functional product can be widely applied in scenarios of large-screen demonstration, video conference, multimedia teaching and other occasions.

2. Features

- ☆ Compliant with HDCP 1.4
- ☆ Video bandwidth is 4.95Gbps
- ☆ Video resolution is up to 1080P@60Hz, 1920x1200@60Hz, as specified in HDMI 1.3
- ☆ Transmission distance can be up to 100m/328ft over CAT6/6a cable
- ☆ Support KVM transmission
- ☆ Support loop out on Transmitter
- ☆ Support audio format up to LPCM 2.0CH
- ☆ Support zero-delay transmission for video/audio signal
- ☆ Support bi-directional PoC function
- ☆ Support EDID copy pass-through on source and sink end

3. Package Contents

- ① 1× 1080P HDMI Extender (Transmitter)
- ② 1× 1080P HDMI Extender (Receiver)
- ③ 1× 12V/1A Multinational Power Supply
- ④ 1× User Manual

4. Specifications

Technical	
HDMI Compliance	HDMI 1.3
HDCP Compliance	HDCP 1.4
Video Bandwidth	4.95Gbps
Video Resolution	Up to 1080p@60Hz, 1920x1200@60Hz
Color Space	RGB_4:4:4, YCbCr_4:4:4, YCbCr_4:2:2
Color Depth	8-bit
Audio Formats	LPCM 2.0CH
Transmission Distance	100m/328ft for 1080p@60Hz over CAT6/6a cable
ESD Protection	IEC 61000-4-2: ±8kV (Air-gap discharge) & ±4kV (Contact discharge)
Connection	
Transmitter	Input: 1× HDMI IN [Type A, 19-pin female] 1× PC [USB-B, 4-pin female] Output: 1× HDMI OUT [Type A, 19-pin female] 1× CAT OUT [RJ45]
Receiver	Input: 1× CAT IN [RJ45] Output: 1× HDMI OUT [Type A, 19-pin female] 1× Keyboard [USB-A, 4-pin female] 1× Mouse [USB-A, 4-pin female]
Mechanical	
Housing	Metal Enclosure
Color	Black
Dimensions	Transmitter / Receiver: 90mm [W] × 68mm [D] × 22mm [H]
Weight	Transmitter: 167g; Receiver: 165g
Power Supply	DC 12V/1A
Power Consumption	PoC (TX->RX): 9.84W; PoC (RX->TX): 5.88W

Operating Temperature	0°C ~ 40°C / 32°F ~ 104°F
Storage Temperature	-20°C ~ 60°C / -4°F ~ 140°F
Operating Humidity	20%~80% relative humidity, non-condensing
Storage Humidity	10%~90% relative humidity, non-condensing

5. Operation Controls and Functions

5.1 Transmitter Panel

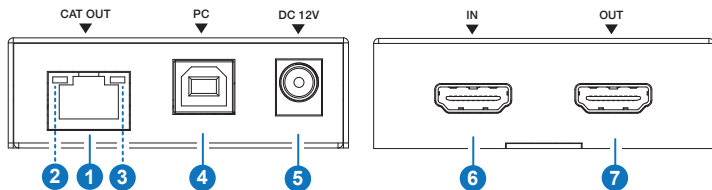

No.	Name	Function Description
1	CAT OUT	Connects to the CAT IN port on Receiver with CAT cable.
2	Left LED (Green)	HDMI signal indicator. It will be on when HDMI input signal is detected.
3	Right LED (Yellow)	Connection signal indicator. <ul style="list-style-type: none"> When TX and RX are connected and signal is transmitted, the LED will flash quickly. When TX and RX are connected but no signal is transmitted, the LED will flash slowly.
4	PC USB Host port	USB host port, connected to a PC.
5	DC 12V	DC 12V/1A power input port, supporting PoC function.
6	HDMI IN	HDMI signal input port, connected to HDMI source device such as DVD or computer host with HDMI cable.
7	HDMI OUT	HDMI signal loop output port, connected to an HDMI display device such as TV or monitor with HDMI cable.

5.2 Receiver Panel

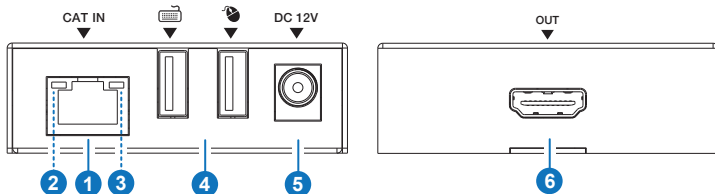

No.	Name	Function Description
1	CAT IN	Connects to the CAT OUT port on Transmitter with CAT cable.
2	Left LED (Green)	HDMI signal indicator. It will be on when HDMI input signal is detected.
3	Right LED (Yellow)	Connection signal indicator. <ul style="list-style-type: none">When TX and RX are connected and signal is transmitted, the LED will flash quickly.When TX and RX are connected but no signal is transmitted, the LED will flash slowly.
4	Keyboard & Mouse	Two USB-A device ports, connected to keyboard and mouse. Note: Please provide power from the Receiver, if a high-power keyboard such as backlit keyboard is connected.
5	DC 12V	DC 12V/1A power input port, supporting PoC function.
6	HDMI OUT	HDMI signal output port, connected to an HDMI display device such as TV or monitor with HDMI cable.

6. Application Example

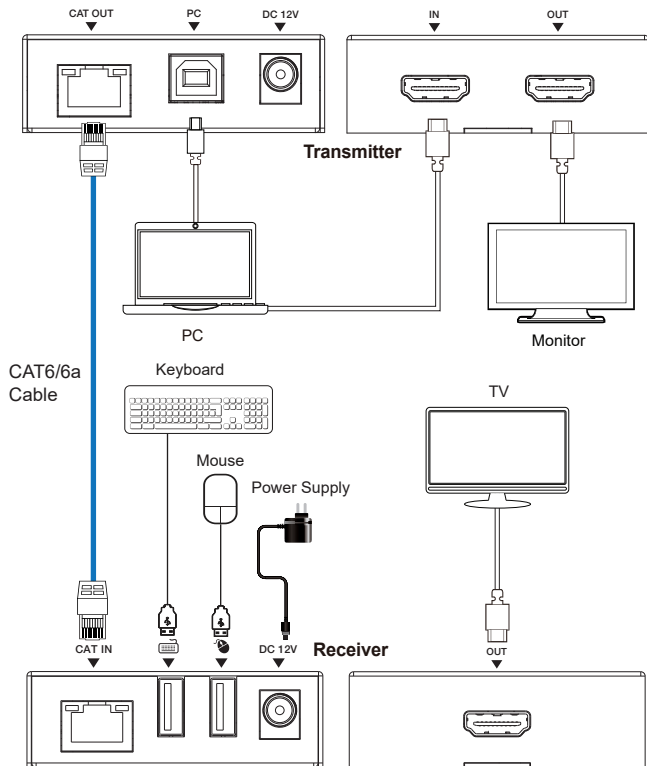

HDMI™
HIGH-DEFINITION MULTIMEDIA INTERFACE

The terms HDMI and HDMI High-Definition Multimedia interface, and the HDMI Logo are trademarks or registered trademarks of HDMI Licensing LLC in the United States and other countries.